

## NEEL 65

### Fast cruising trimaran

Architects : Joubert/Nivelt

Design : FRANCK DARNET DESIGN

Shipyard: NEEL Trimaran



Length: 19.8 m

Beam: 12.05 m

Draught: 1,80 m

Half load displacement: 22.5 T

Engine: 150 HP

## The PROJÉT > TO AID IN THE PROCUREMENT OF THE CERTIFICATION OF THE NEEL 65 SERIES TRIMARAN

### Description

> A glass / Isophthalic Polyester Resin / Closed-cell foam and honeycomb PVC sandwich construction > Interior features designed for 16 people > Trimaran designed for fast cruising.

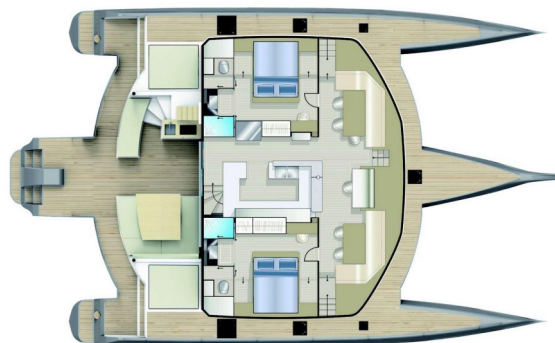

### Project schedule

	2014	2015
Creation of folders and documents	■	
Certification		■

## YACHT CONCEPT'S MISSIONS

### Project management

- > Management of the trimaran certification.
- > Program development and follow-up of all administrative tasks.
- > Project coordination between the ICNN, the architect, the design and structural analysis department, the subcontractors and the certifying organization.
- > Assisting the technical files and the documents redaction.

### Engineering

- > Finishing of the plans and the documents.
- > Implementation and management of the procedures leading to yacht classification and registration.

